

**PUBLIC PATH DIVERSION ORDER
TOWN AND COUNTRY PLANNING ACT 1990 SECTION 257
THE STAFFORDSHIRE MOORLANDS DISTRICT COUNCIL
FOOTPATH 28 (PART) CAVERSWALL
PUBLIC FOOTPATH DIVERSION ORDER JULY 2018**

This order is made by the Staffordshire Moorlands District Council under section 257 of the Town & Country Planning Act 1990 because it is satisfied that it is necessary to divert the footpath to which this order relates in order to enable development to be carried out in accordance with planning permission granted under Part III of the Town and Country Planning Act 1990 namely proposed extensions and alterations to existing structures at Coyney Grove Farm, March Lane, Cellarhead, planning ref: SMD/2017/0379.

BY THIS ORDER

1. The footpath number 28 over the land shown by a solid black line on the attached map and described in Part 1 of the Schedule to this order (the Schedule") shall be diverted as provided below.
2. There shall be created to the reasonable satisfaction of Staffordshire Moorlands District Council an alternative highway for use as a replacement for the said footpath as provided in Part 2 of the Schedule and shown by bold black dashes on the attached map.
3. The diversion of the footpath shall have effect on the date on which Staffordshire Moorlands District Council certify that the terms of Article 2 above have been complied with.
4. The following works shall be carried out in relation to the highway described in Part 2 of the Schedule: The diverted length of footpath between points A - D - C shall be a minimum of two metres wide and with a solid bound surface.
5. Mr & Mrs Granger of Coyney Grove Farm, March Lane, Cellarhead are required to carry out and pay for the cost of carrying out the said works (insofar as they are not already in existence).
6. Where immediately before the date on which the footpath is diverted there is apparatus under, in, on, over, along or across it belonging to statutory undertakers for the purpose of carrying on their undertaking, the undertakers shall continue to have the same rights in respect of the apparatus as they then had.

SCHEDULE

PART 1

DESCRIPTION OF SITE OF EXISTING PATH OR WAY

Section indicated on Map A - B - C

The whole width and length of Footpath 28 Caverswall from point A (396178 347088) proceeding in a generally southerly direction to point B (396173 347067) then in a westerly direction to point C (396146 347050). Points A through B to C in bold on the plan will be closed (approximately 48 metres).

PART 2

DESCRIPTION OF SITE OF ALTERNATIVE PATH OR WAY

Section indicated on Map A - D - C

A minimum of a 2 metre wide solid bound surfaced footpath from point A (396178 347088) and in a westerly direction to point D (396145 347076) then in a southerly direction to point C (396146 347050) for a total distance of 46 metres or thereabouts.

THE COMMON SEAL of the
STAFFORDSHIRE MOORLANDS DISTRICT COUNCIL

Was hereunto affixed this 1st day of August 2018
in the presence of:-

Chairman



Chief Executive Officer



Chairman

Chief Executive

Duh

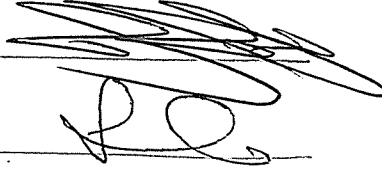

8620

KEY

- Broken grey line ----- indicates unaffected route of existing line of footpath 28 Caverswall
- Continuous black line _____ points A to B to C existing line of footpath 28 Caverswall to be closed
- Broken black line - - - - - points A to D to C proposed line of diverted footpath 28 Caverswall
- Coordinates: Point A (396178 347088), Point B (396173 347067), Point C (396146 347050) and point D (396145 347076)

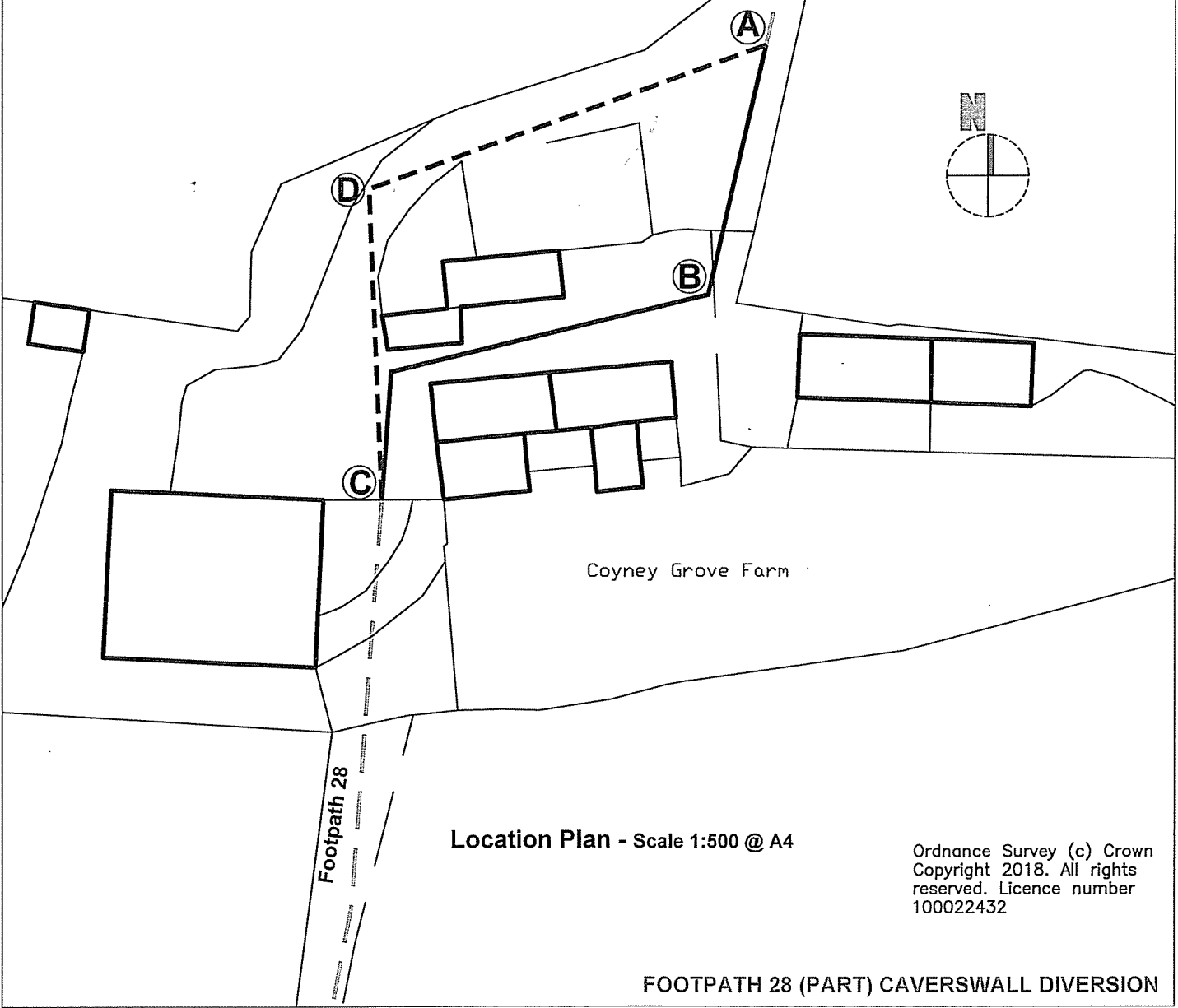

Location Plan - Scale 1:500 @ A4

Ordnance Survey (c) Crown
Copyright 2018. All rights
reserved. Licence number
100022432